

Connectivity Device SendPro Install Instructions

The Connectivity Device SendPro enables you to add funds, perform automatic updates, and receive alerts using a cellular 4G network.

What's in the Box

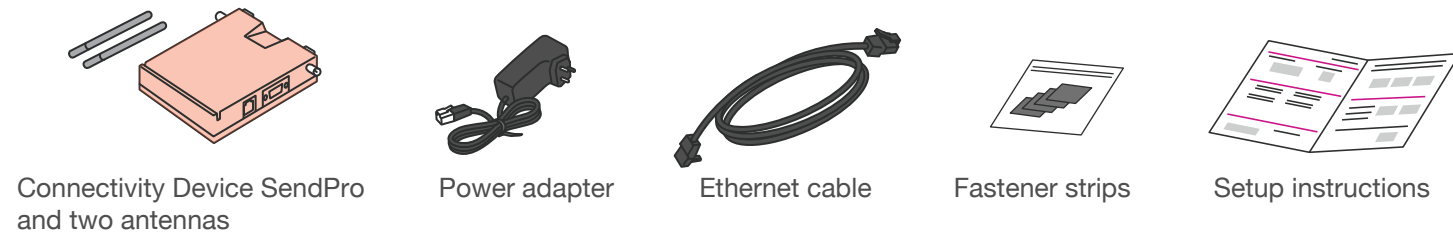

1. Assemble the antennas to the Connectivity Device.

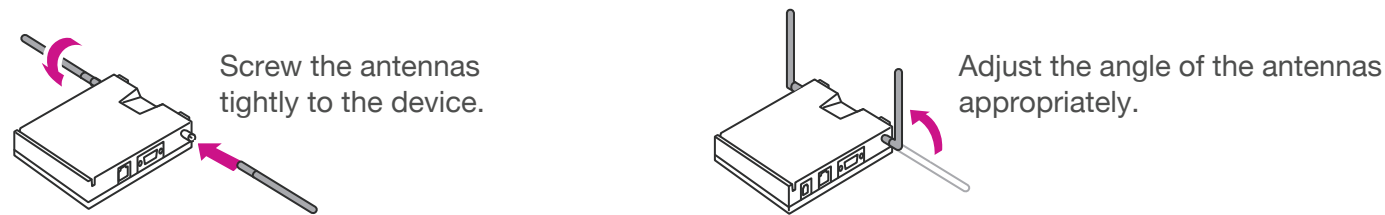

2. Plug the Ethernet cable.

 **Power up the sending device before connecting the cable.**

- 1 Plug the Ethernet cable to the () port at the back of your sending device. (Your sending device would be either SendPro C or SendPro P)
- 2 Then plug the other end to the connectivity device.

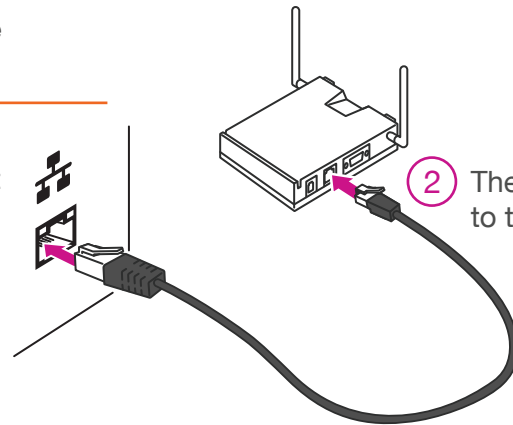

3. Power up the Connectivity Device and check power indicator.

Plug the power adapter to the RJ12 port on the connectivity device and into a power outlet.

Once power is on, the first LED will turn solid green.

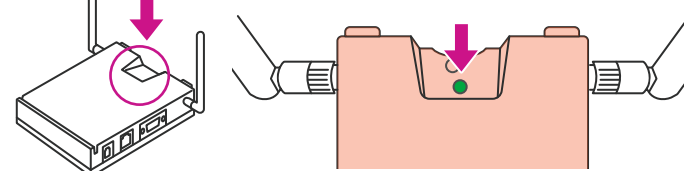
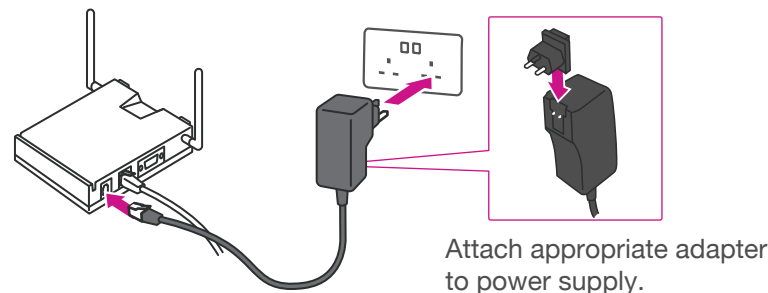

 If the LED is not lighting up, Visit the Pitney Bowes Support site located at the end of instructions.

4. Check connection indicator.

The second LED will flash orange, if it has not flashed. Visit the Pitney Bowes Support site located at the end of instructions.

In about 3 ~ 5 minutes it should turn to solid orange, if it has not happened, try the following procedure A or B.

Once it turns to solid orange, signifying that the connection is live, move to step 5.

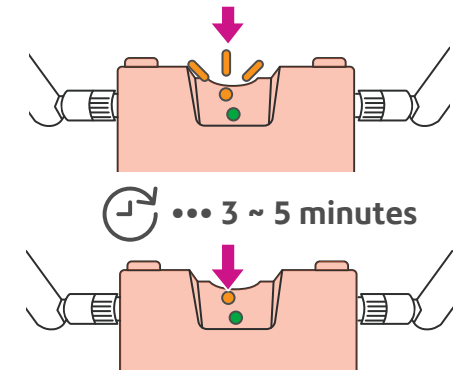

Procedure A

Move the device at least 1 meter away from any electric appliances that could be causing interference. You might relocate your sending device together or use a longer Ethernet cable if available.

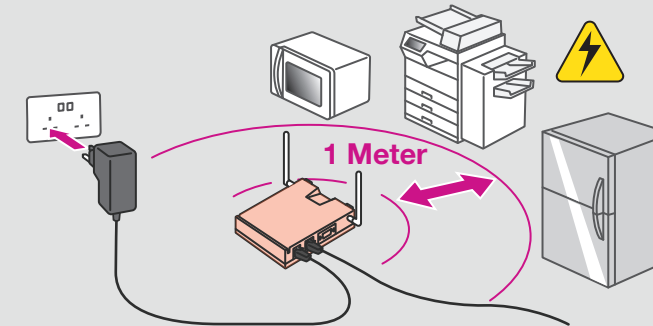

Procedure B

Move the device closer to a window or outside wall. You might relocate your sending device together or use a longer Ethernet cable if available.

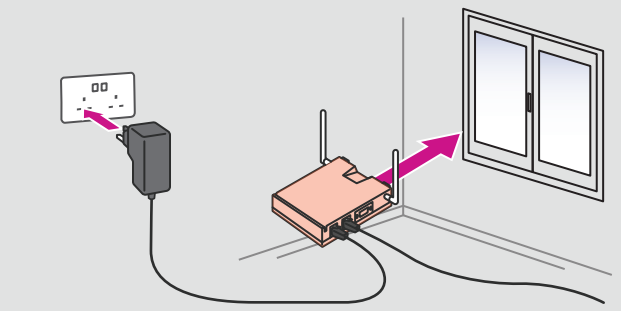

Plug in the power adapter then check the orange LED colour. If it turns to only solid orange, move to step 5.

 If the orange LED is still not turning to solid orange. Visit the Pitney Bowes Support site located at the end of instructions.

5. Check for flashing green LED.

You will see a flashing green LED light between the Ethernet cable port and the RJ12 port. Your sending device is ready for you to use.

Using the Velcro strips provided, secure the device as needed.

Make sure to apply a velcro strip in the middle of the back of the device. Ensure not cover any labels.

